

MOPTECH

INTERNATIONAL INC.



COMPONENTS FOR THE
SANITARY SUPPLY INDUSTRY



MOPTECHINT.COM

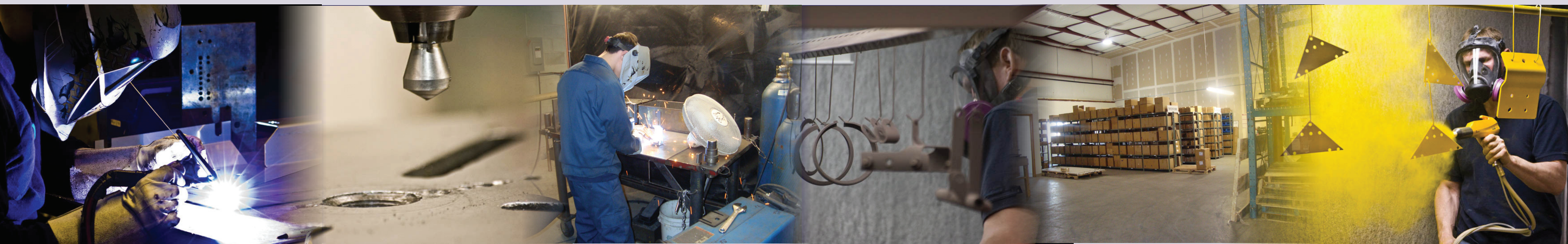

MOPTECH HISTORY

MOPTECH was founded in 1996 with a focus on manufacturing Mop frames and components for the sanitary supply industry. Over the course of 14 years, MOPTECH has grown to become a world leader in the design and manufacturing of industrial sanitary supply equipment.

MOPTECH takes a project management approach to ensure on time delivery, quality control and cost management.

In 2009, MOPTECH was acquired by Normont Industrial which gives MOPTECH a host of World Class support:

- *Manufacturing Facilities:* Granby (QC), Québec (QC), Champlain (NY), New York City (NY), Cixi (China)
- *Manufacturing Capabilities:* Tool & Die making, Stamping, Welding, Fabricating, Machining, Powder Coating, Assembly
- *Engineering Services:* Product design & development, 3-D modeling, Stereo lithography, Finite Element Analysis
- *Warehousing Facilities:* Laval (QC), Calgary (AB), Plattsburgh (NY), New York City (NY) and Mexico City (Mexico)

ABOUT NORMONT INDUSTRIAL



Normont Industrial is recognized as a leader in the design, manufacturing and supply of industrial and access hardware. Our World Class team of Professional Engineers will analyse the specific requirements of each new request whether it be for hinges, gas springs, battery trays or engine cradles and develop an innovative quality and cost effective solution for that application. Normont's capabilities include Powder Coating, Stamping, Machining, Fabricating, Welding and Assembly. The Normont team is ready to deliver custom engineered solutions that are innovative, high in quality and cost effective.

POWDER COATING: A Better Solution for the Environment.

MOPTECH has the ability to Powder Coat any product that is fabricated in-house. This gives MOPTECH the flexibility in the production process to reduce the lead time to the customer.

- Powder Coating produces a much thicker coating than conventional paint without running, chipping or corroding
- Powder Coated finishes are resistant to many chemicals including brake fluids and fuels
- Powder Coating is environmentally friendly and VOC compliant

PRODUCTS

MOPTECH provides specialized high quality industrial sanitary supply components. MOPTECH products can be used in various application areas such as general building, warehouse and office maintenance. MOPTECH can also customize fabrication based on the customer's needs.

MOPTECH uses a state-of-the-art Robotic Welding machine giving accuracy which allows for a quicker turn-around of high-quality finished products.

TO CONTACT A REPRESENTATIVE

To contact a representative, please call toll free at 1-888-286-MOPS (6677) or email at info@moptechint.com.

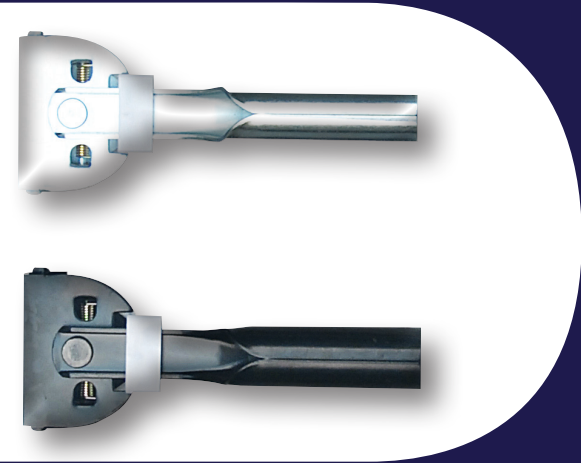

SWIVEL HEAD
CLIP-ON-CONNECTOR

This head can swivel 180° with a plastic lock ring.
The swivel head comes in two colors:

- Black
- Zinc Plated

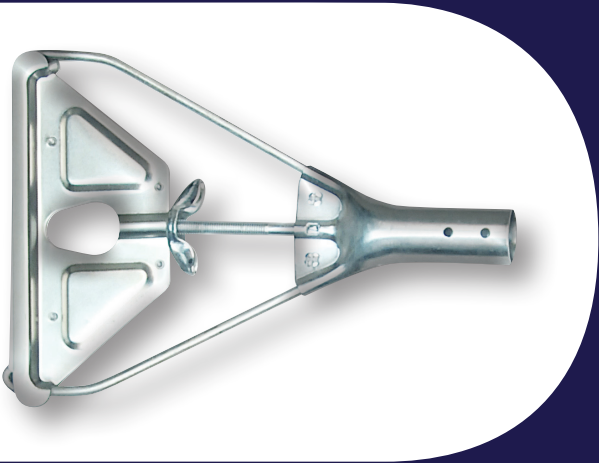

WET MOP HANDLE

This heavy-duty wet mop handle has a quick release cross bar for fast mop head changes and a secure hold.

Made of Zinc plated metal to prevent rust and corrosion, these mop handles are designed for use with heavy-duty wing nuts and screw clamps.

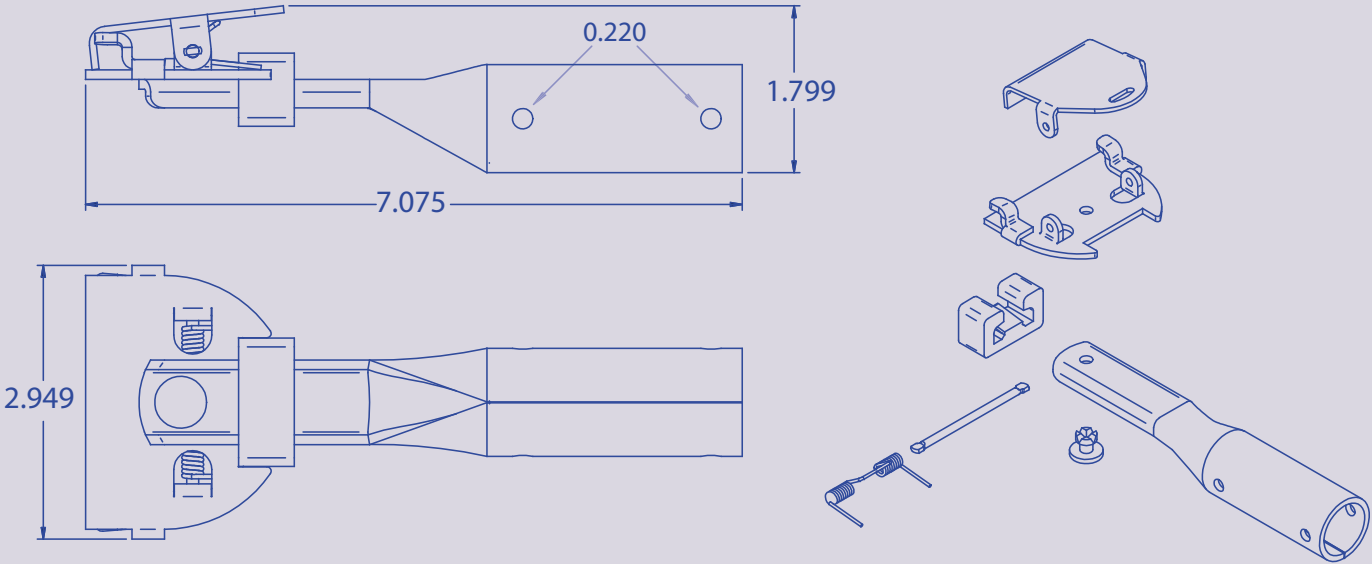

DESCRIPTION	BLACK	ZINC
Swivel head clip-on-connectors	MT1516B	MT1516Z

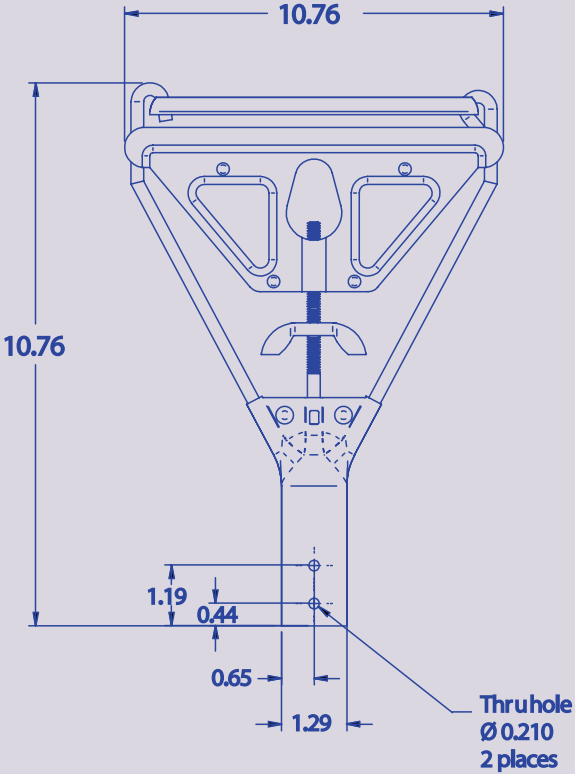

DESCRIPTION	ZINC PLATED
Wet Mop Handle - cold rolled mild steel	MTWM

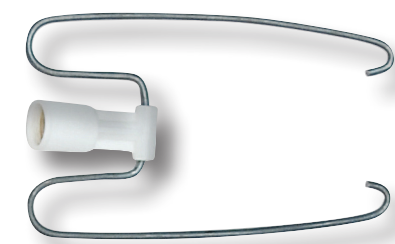

WEDGE MOP

For dust mopping in tight corners, under equipment or behind furniture. The wedge length comes in three sizes:

- 6 in.
 - 7 in.
 - 8 in.
- Wire diameter

 - .144 in.
 - .144 in.
 - .160 in.

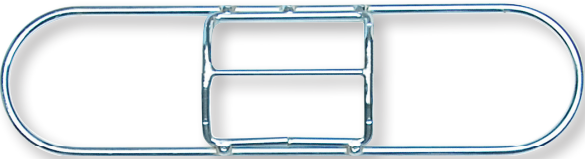

STANDARD DUST MOP FRAME

Durable wire-loop frames are designed to be used with any tie-on style dustmops. Several lengths available in three colors:

- Black
- Silver
- Zinc

Wire diameter: 0.232 in.

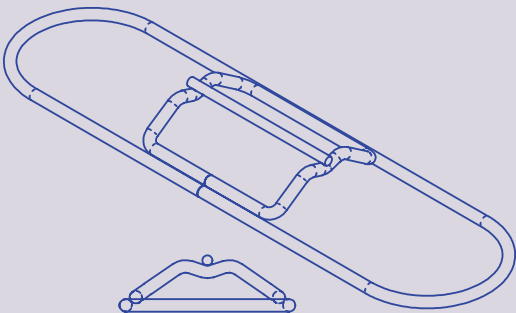
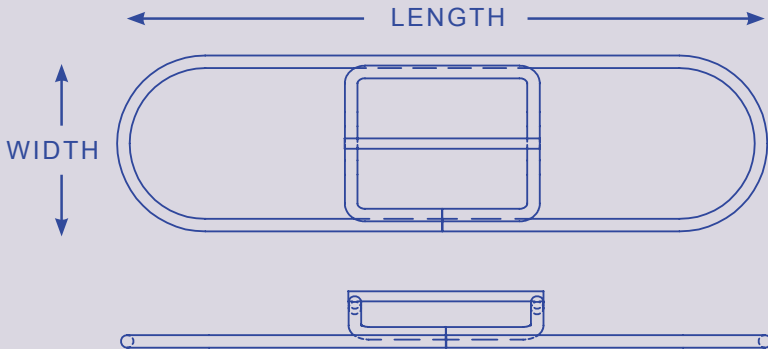
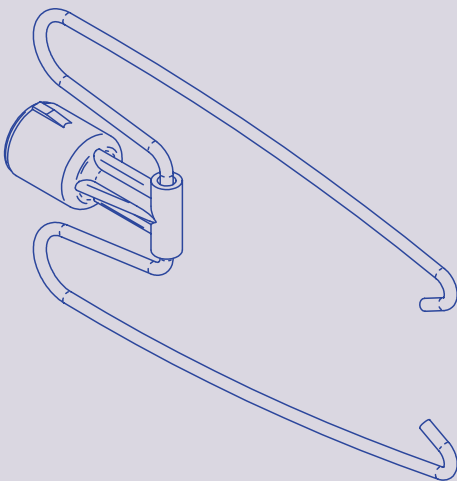
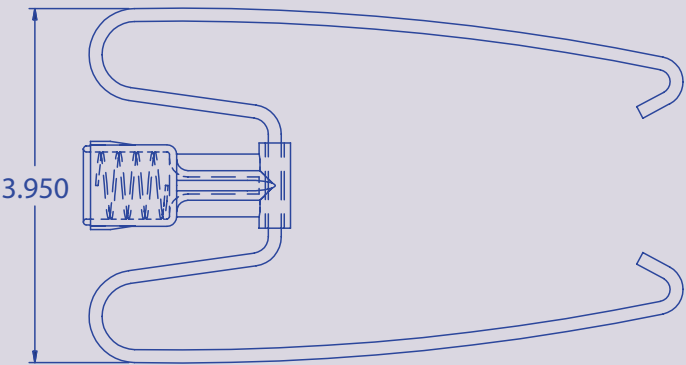

DESCRIPTION	6 INCH	7 INCH	8 INCH
Wedge Mop	MT21	MT27	MT30

WIDTH / LENGTH	BLACK	SILVER	ZINC
3.25 x 12	MT312SXB	MT312SXS	MT312SXZ
3.25 x 18	MT318SXB	MT318SXS	MT318SXZ
3.25 x 24	MT324SXB	MT324SXS	MT324SXZ
3.25 x 30	MT330SXB	MT330SXS	MT330SXZ
3.25 x 36	MT336SXB	MT336SXS	MT336SXZ
3.25 x 42	MT342SXB	MT342SXS	MT342SXZ
3.25 x 48	MT348SXB	MT348SXS	MT348SXZ
3.25 x 60	MT360SXB	MT360SXS	MT360SXZ
3.25 x 72	MT372SXB	MT372SXS	MT372SXZ
5 x 12	MT512SXB	MT512SXS	MT512SXZ
5 x 18	MT518SXB	MT518SXS	MT518SXZ
5 x 24	MT524SXB	MT524SXS	MT524SXZ
5 x 30	MT530SXB	MT530SXS	MT530SXZ
5 x 36	MT536SXB	MT536SXS	MT536SXZ
5 x 42	MT542SXB	MT542SXS	MT542SXZ
5 x 48	MT548SXB	MT548SXS	MT548SXZ
5 x 60	MT560SXB	MT560SXS	MT560SXZ
5 x 72	MT572SXB	MT572SXS	MT572SXZ

WIDTH / LENGTH	BLACK
4.25 x 12	MT412SXB
4.25 x 18	MT418SXB
4.25 x 24	MT424SXB
4.25 x 30	MT430SXB
4.25 x 36	MT436SXB
4.25 x 42	MT442SXB
4.25 x 48	MT448SXB
4.25 x 60	MT460SXB
4.25 x 72	MT472SXB

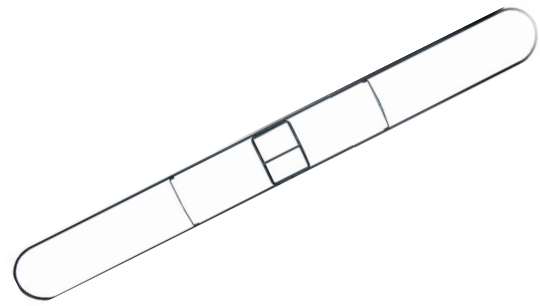

DUST MOP FRAME WITH BRACE

Ideal to reinforce larger dust mops. Makes a heavy duty large dust mop frame more durable and provides extra support for the handle which helps distribute the weight for better control.

All frames are constructed of a mild steel wire and either Powder Coated or Zinc plated.

Wire diameter: 0.232 in.

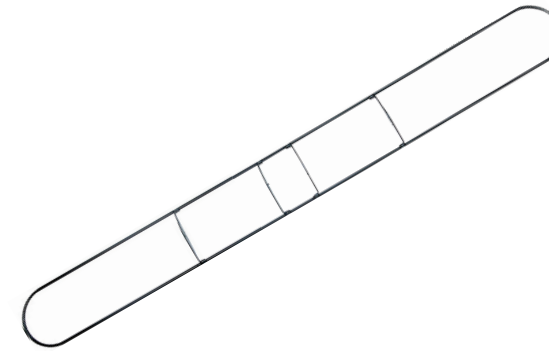

DUST MOP FRAME WITH CONNECTOR AND BRACE

Ideal to reinforce larger dust mops from 48" and larger. Makes a heavy duty large dust mop frame more durable and provides extra support for the handle which helps distribute the weight for better control.

All frames are constructed of a mild steel wire and either Powder Coated or Zinc plated.

Wire diameter: 0.232 in.

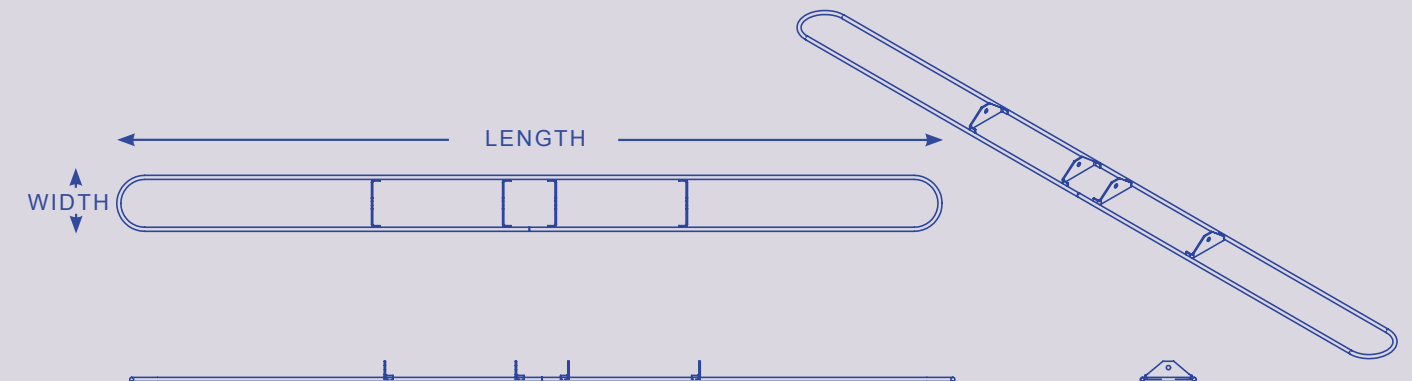
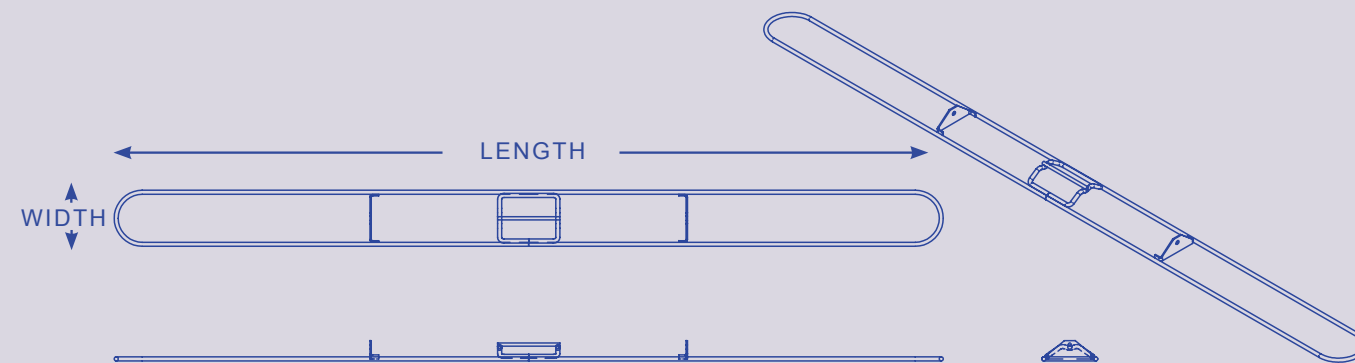

WIDTH / LENGTH	BLACK	SILVER	ZINC
3.25 x 48	MT348SBB	MT348SXS	MT348SBZ
3.25 x 60	MT360SBB	MT360SXS	MT360SBZ
3.25 x 72	MT372SBB	MT372SXS	MT372SBZ
5 x 48	MT548SBB	MT548SXS	MT548SBZ
5 x 60	MT560SBB	MT560SXS	MT560SBZ
5 x 72	MT572SBB	MT572SXS	MT572SBZ

WIDTH / LENGTH	BLACK	SILVER	ZINC
3.25 X 48	MT348CBB	MT348CBS	MT348CBZ
3.25 X 60	MT360CBB	MT360CBS	MT360CBZ
3.25 X 72	MT372CBB	MT372CBS	MT372CBZ
5 X 48	MT548CBB	MT548CBS	MT548CBZ
5 X 60	MT560CBB	MT560CBS	MT560CBZ
5 X 72	MT572CBB	MT572CBS	MT572CBZ

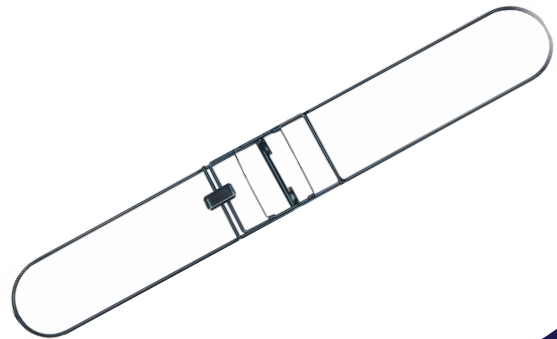

BREAK-AWAY FRAME

The Break-Away frame features a rotating locking lever that securely locks the frame when in use. The Break-Away frames swivel 360° degrees at all angles to provide the most versatile, dust control tool.

All frames are constructed of a mild steel wire and either Powder Coated or Zinc plated.

Frames are available in lengths from 18" to 60".
Wire diameter: 0.232 in.

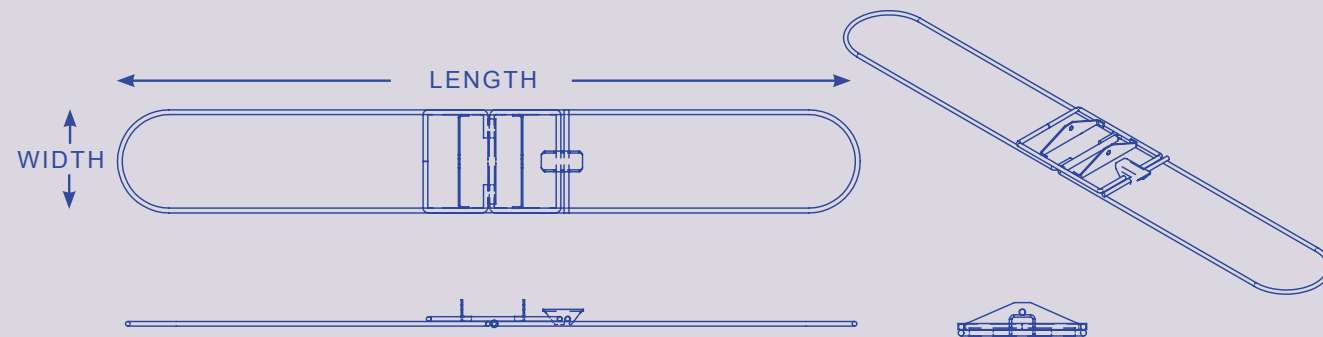

WIDTH / LENGTH	BLACK	ZINC
5 x 18	MT518BAB	MT518BAZ
5 x 24	MT524BAB	MT524BAZ
5 x 36	MT536BAB	MT536BAZ
5 x 42	MT542BAB	MT542BAZ
5 x 48	MT548BAB	MT548BAZ
5 x 60	MT560BAB	MT560BAZ

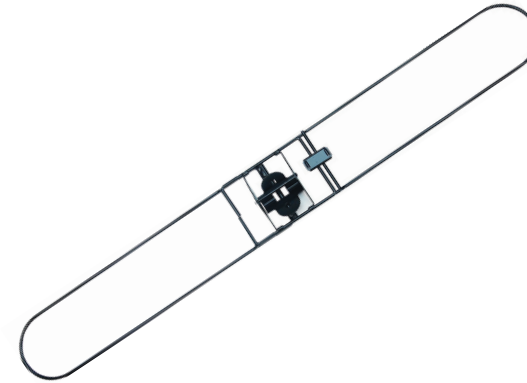

BOLT-ON FRAME

Heavy duty long lasting frames are collapsible and can be used on break-away and tie-on style dustmops. These durable industry standard frames feature a unique handle connecting system with no loose parts.

All frames are constructed of a mild steel wire and either Powder Coated or Zinc plated.

Frames are available in lengths from 18" to 60".
Wire diameter: 0.232 in.

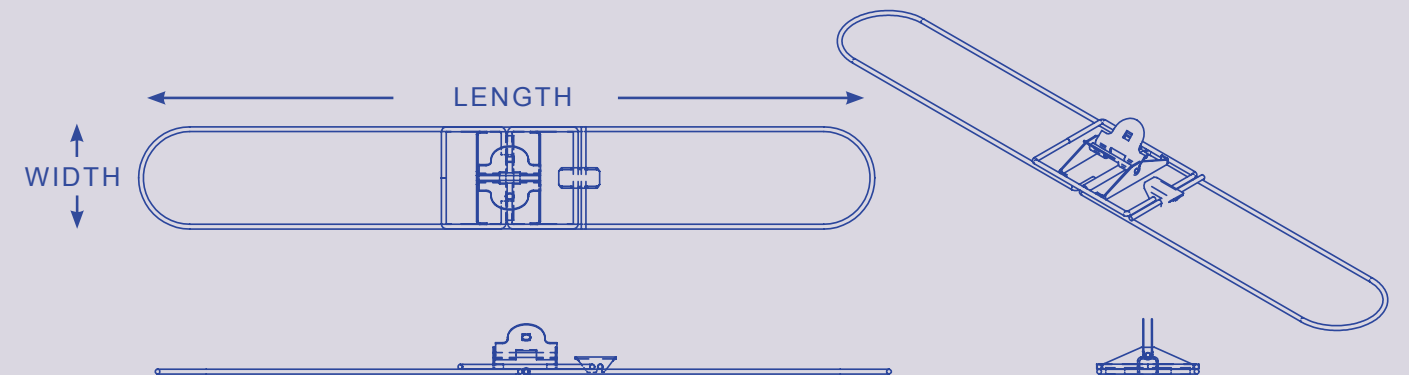

WIDTH / LENGTH	BLACK	ZINC
5 X 18	MT518BOB	MT518BOZ
5 X 24	MT524BOB	MT524BOZ
5 X 36	MT536BOB	MT536BOZ
5 X 42	MT542BOB	MT542BOZ
5 X 48	MT548BOB	MT548BOZ
5 X 60	MT560BOB	MT560BOZ

MOPTECH



INTERNATIONAL INC.



COMPONENTS FOR THE SANITARY SUPPLY INDUSTRY

MOPTECH International Inc.
3072 Joseph-Monier, Terrebonne, Québec., J6X 4R1

Tel: 450-477-2258
Fax: 450-477-1377
Toll Free: 1-888-286-MOPS (6677)

www.moptechint.com
info@moptechint.com



A division of Normont Industrial



www.normont.com